

Wireless Contact RAC (869.2125) – Set-up Information

The Wireless Contact RAC (called RAC thereafter) can be used for activity monitoring operations managed by TeleAlarm Carephones or for transmission of specific events.

When used as activity monitoring, the Carephone can initiate a call for help automatically when there is no sign of activity during a certain lapse of time.

When used as a transmitter for specific events, the alarm can be activated by approaching and/or moving away a magnet, or by the opening and/or closing of an electrical contact.

Installation

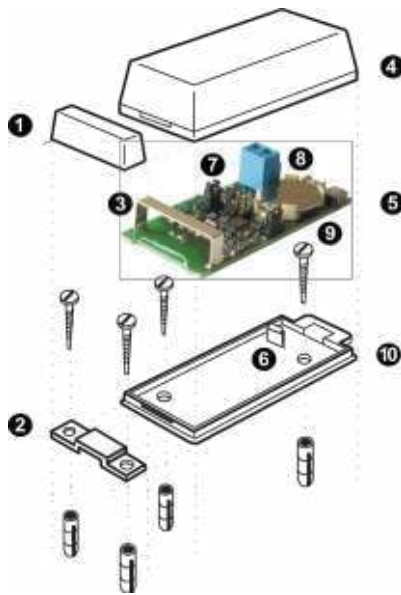

Magnet:

- ❶ Housing with magnet
- ❷ Bottom plate

Radio Transmitter:

- ❸ REED Contact
- ❹ Top Lid
- ❺ PCB assembly
- ❻ Clip
- ❼ Jumper
- ❽ Battery
- ❾ Battery holder
- ❿ Bottom plate

Recommendations:

- Allow a minimum height of 20 cm from the ground.
- Do not use on metal surfaces.
- Install the magnet on the moving part (door or window) and the radio transmitter on the frame.
- Avoid using "double side" adhesive tape.
- The RAC is not waterproof.

Open lid ❹ of the radio transmitter by pressing on the two narrow sides. Remove the printed circuit board ❺ by pressing on clip ❻ from the bottom plate ❿.

Do not touch the electronic components.

The bottom plate ❿ of the radio transmitter is fixed by two screws.

Replace the printed circuit board ❺ carefully, install the battery ❽ with the positive pole (+) to the top and the negative pole (-) against the battery holder ❾. Close lid ❹.

The RAC features two REED contacts ❸. Their positions are indicated on lid ❹ by two arrows. The bottom plate ❷ of the magnet is secured by two screws. The spacing between the radio transmitter and the magnet should not exceed **10 mm** in the closed state (check the matching of the arrows on the two lids). Close the lid ❶.

Use only one single magnet per radio transmitter.

Configuration and wiring

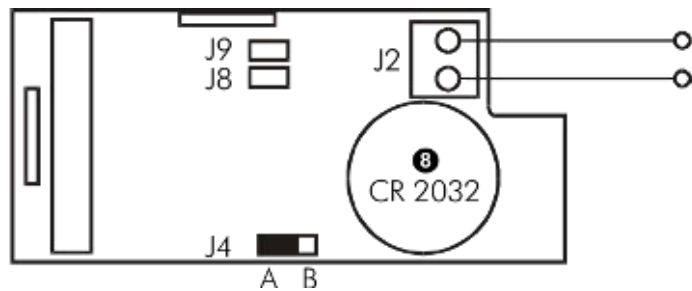

Configuration and wiring must be done before placing the battery in the battery holder.

External Alarm input

The RAC features two screw terminals for connecting an external electrical floating contact. The cable length should not exceed 2 m.

Jumper	Position	Description
J8	set	The radio message is transmitted by opening the external contact J2
J9	set*	The radio message is transmitted by closing the external contact J2

*Delivery

If both jumpers J8 or J9 are removed, the contact or the magnet will **not** generate any radio signal. On the other hand, it is possible to place both jumpers J8 and J9. The radio message will then be sent by both the closing **and** the opening of the external contact, or by approaching **and** moving away the magnet.

Magnet

The transmission of the radio message depends on jumper J4 as well as J8 and J9:

Jumper	Position	Description
J4	A*	The RAC reacts the same way to the magnet and to the external contact: <ul style="list-style-type: none"> ▪ J8 set, the radio message is sent when the magnet is moving away ▪ J9 set*, the radio message is sent when the magnet is approaching
	B	The RAC reacts the opposite way to the magnet and to the external contact: <ul style="list-style-type: none"> ▪ J8 set, the radio message is sent when the magnet is approaching ▪ J9 set*, the radio message is sent when the magnet is moving away

* Delivery

Programming

The RAC needs to be registered in the Carephone. Please refer to the User's Manual of the unit.

Operation check

It is strongly recommended to perform an operation check of the installation on a regular basis.

Replacing the battery

The battery can generate up to 5000 radio transmissions in a period of up to 3 years. Open lid ④ of the radio transmitter by pressing on the two narrow sides and replace the battery ⑧ (Use a 3V lithium battery of type CR 2032) with the positive pole (+) to the top and the negative pole (-) against the battery holder ⑨. Close lid ④.

Do not touch the electronic components.